

# LED Retrofit Kit

*Most Flexible and Reliable Design*

**5 YEAR WARRANTY**

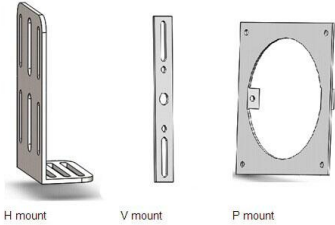

## **Application:**

- Wall pack
- Street light
- High bay
- Canopy
- Shoebox

40W / 60W / 80W / 100W / 120W / 150W / 185W / 240W / 320W / 400W



## **Overview**

An elegant new design with 2nd-generation retrofit kit, utilizes **CREE XTE LED** luminous source and high reliable **MEAN WELL HLG Series LED** driver, accepts 90-305VAC, consumes 40W to 400W and produces light intensity equivalent to 150W to 1000W MH fixtures. The RTUV retrofit kit comes pre-fit your existing fixture, allowing fast and easy change out.

**Martek Industries, Inc**  
The Experts in Responsible Lighting  
600 Deer Rd, Bldg 8  
Cherry Hill, NJ 08034  
[www.marteklighting.com](http://www.marteklighting.com) 856-427-9411



## Product Benefits

- High performance **LG 3030**, market available high performance **CREE LEDs**
- **MEANWELL** driver, all range **WL-RTUV** utilizing **MEANWELL HLG** series high-end driver, great luminaire stability, lifespan and optimal performance status. Made in Taiwan, real warranty 5-year
- **Sunon® LED fan**, DR Megles series, +50,000 hours life. Equipped with strain relief clamp, electrical cables and soldering points can be well protected.
- Equipped with **Wago® quick disconnect** between LED driver and LED module. Easily and fast connect.
- Professional and clean design with **Wago® SMD PCB** connector
- **Thermal protector** can automatically dim down or switch off LED module is over heat detected and automatically switch on LED module when it cools down.
- **Die casting aluminum heat sink**. One piece die casting aluminum heat sink ensures heat dissipation of LED module. Available finish color: silver, white
- **Flexible Installation**



### Horizontal Mount with L-Bracket

Instead of mounting by mogul base, WL-RTUV is mounted by "L" bracket which fits mogul base location inside of most conventional fixtures. The "L" bracket is made of one piece metal plate with variable pre-drilled holes to fit existing mogul base location, and can be secured by

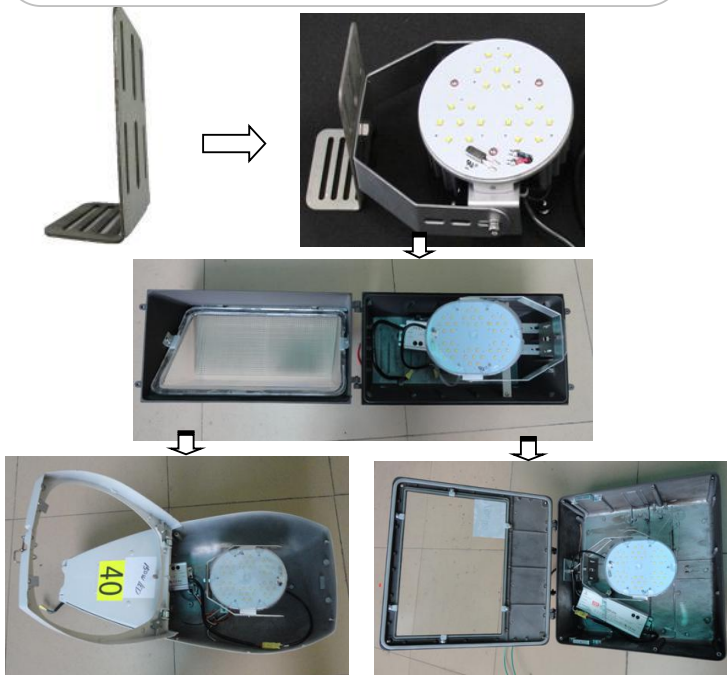

### Vertical Mount with I-Bracket

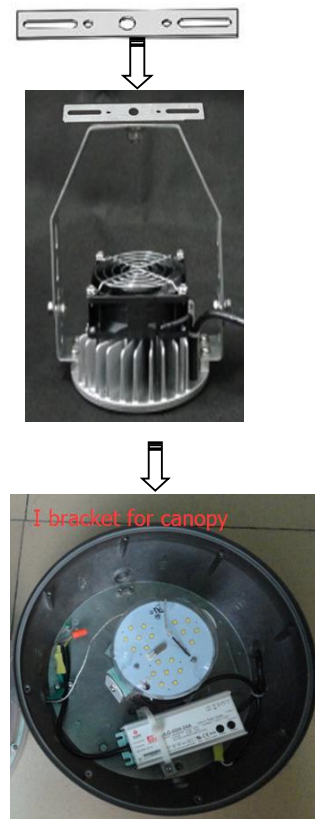

### Pre-Plate

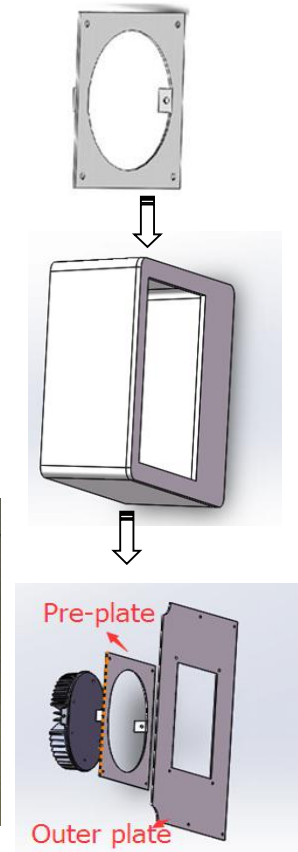

Martek Industries, Inc  
 The Experts in Responsible Lighting  
 600 Deer Rd, Bldg 8  
 Cherry Hill, NJ 08034  
 www.marteklighting.com 856-427-9411



# Ordering Information

MODEL	LED WATTAGE	VOLTAGE	LED Q'ty	REPLACEMENT S	BEAM ANGLE	LUMENS	CRI	DIMENSIONS (L×W×H)	CCT
ML-RTUV-040	40W	90-305VAC /47-63Hz	88	125W MH	120° 45°	5000	70	D120×H62mm	5000K 5500K 5700K
ML-RTUV-060	60W		88	175W MH	120° 45°	5000	70	D120×H62mm	
ML-RTUV-080	80W		144	250W MH	120° 45°	10000	70	180×140×78mm	
ML-RTUV-100	100W		144	350W MH	120° 45°	12500	70	180×140×78mm	
ML-RTUV-120	120W		180	400W MH	120° 45°	15000	70	180×140×78mm	
ML-RTUV-150	150W		220	450W MH	120° 45°	18750	70	180×140×78mm	
ML-RTUV-185	185W		280	600W MH	120° 45°	23125	70	265×160×79mm	
ML-RTUV-240	240W		360	800W MH	120° 45°	30000	70	265×160×79mm	
ML-RTUV-320	320W		480	1000W MH	120° 45°	40000	70	320×237×85mm	

MODEL (Optional)	DESCRIPTION
ML-RTUVSVFN	Silver finish (Default Color)
ML-RTUVWHFN	White Finish
ML-RTUVHM	Horizontal Mount(L)
ML-RTUVVM	Vertical Mount(I)
ML-RTUVCP	Custom Plate

OPTICS OPTIONS	
45D	45Deg.Lens
120D	No Lens

## Installation Instruction

1. Remove existing ballast, bulb, socket and reflector.
  2. Fix LED driver using screws via mounting brackets of driver within the fixture at ballast location. Connect input end of driver to AC power source inside existing fixture.
  3. Mount provided "L" bracket ("I" bracket optional) at existing socket location. Fix LED module with "L" bracket ("I" bracket optional) inside the fixture using provided screws and position LED module for maximum light output. You may customize a mounting plate to fix LED module.
  4. Connect LED module and LED driver using the provided connector.
- Connect ground wire of driver to ground wire or ground terminal of the luminaires or branch circuit grounding conductor.

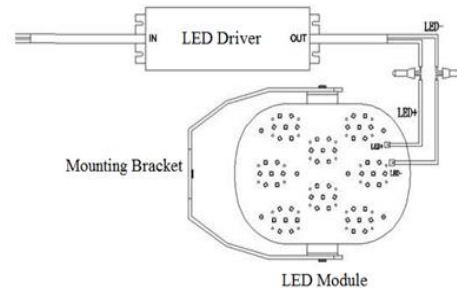
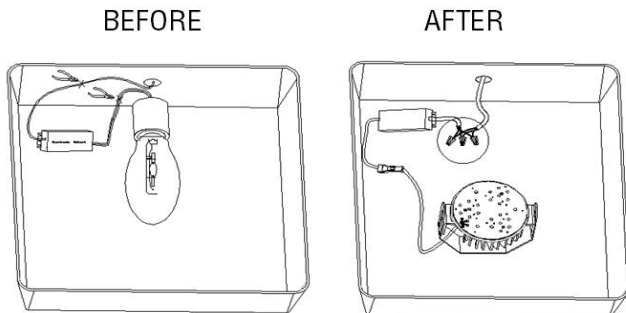

Martek Industries, Inc  
 The Experts in Responsible Lighting  
 600 Deer Rd, Bldg 8  
 Cherry Hill, NJ 08034  
[www.marteklighting.com](http://www.marteklighting.com) 856-427-9411



# ML-RTUV-040



## Specification

### ELECTRICAL MEASUREMENTS

Input voltage	90-305VAC, 47-63 Hz
Input wattage	40W
Input current	0.43A
Equivalent wattage	125W MH
Power factor	0.90min
Total harmonic distortion	20% max.
Operating temp.	"-40°C to +45°C"

### PHOTOMETRIC CHARACTERISTICS

Initial Lumens Output	5000Lm
Initial Lumen Efficacy	125 lm/W
CCT	5000K/5500K/5700K
CRI	>70
Optics	120 deg./45 deg. (optional)

### LUMINOUS INTENSITY DISTRIBUTION

Center beam candlepower	1276cd
Beam angle	114.7° /45°

### PHYSICAL SPECIFICATION

Diameter	4.72" (120mm)
Height	2.44" (62mm)
Housing material	Die cast aluminum
Finish	Silver
Module Weight	680g
Driver Weight	658g
Packing Type	1 unit/white box, 4 boxes/ctn.
Packing Dimension	410*295*150mm/425*310*320mm
Packing Weight	1.88kg/7.5kg

### MOUNTING AND WIRING

Mounting	Horizontal mounting Or vertical mounting Or custom plate mounting
----------	---

*\*Photometric values based upon tests performed in compliance*

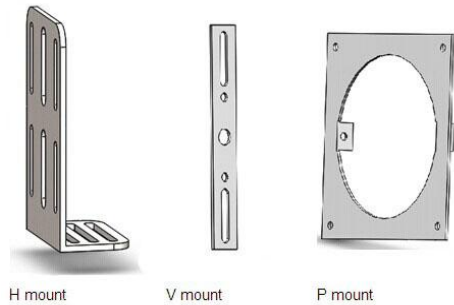

## Photometric Data

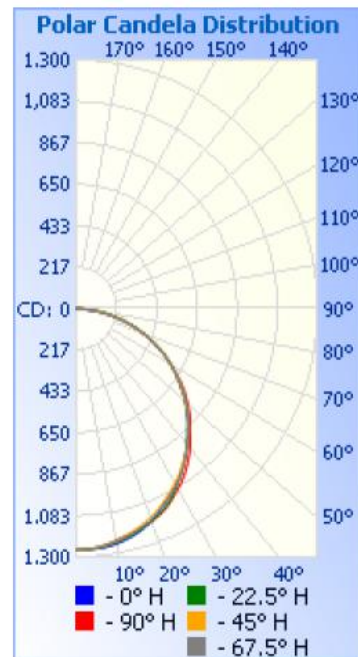

**Martek Industries, Inc**  
**The Experts in Responsible Lighting**  
**600 Deer Rd, Bldg 8**  
**Cherry Hill, NJ 08034**  
**www.marteklighting.com 856-427-9411**





# ML-RTUV-060



## Specification

### ELECTRICAL MEASUREMENTS

Input voltage	90-305VAC, 47-63 Hz
Input wattage	60W
Input current	0.64A
Equivalent wattage	175W MH
Power factor	0.90min
Total harmonic distortion	20% max.
Operating temp.	"-40°C to +45°C"

### PHOTOMETRIC CHARACTERISTICS

Initial Lumens Output	7500Lm
Initial Lumen Efficacy	125Lm/W
CCT	5000K/5500K/5700K
CRI	>70
Optics	120 deg./45 deg. (optional)

### LUMINOUS INTENSITY DISTRIBUTION

Center beam candlepower	1738cd
Beam angle	115.1° /45°

### PHYSICAL SPECIFICATION

Diameter	4.72" (120mm)
Height	2.44" (62mm)
Housing material	Die cast aluminum
Finish	Silver
Module Weight	680g
Driver Weight	658g
Packing Type	1 unit/white box,4 boxes/ctn.
Packing Dimension	410*295*150mm/425*310*320mm
Packing Weight	1.88kg/7.5kg

### MOUNTING AND WIRING

Mounting	Horizontal mounting Or vertical mounting Or custom plate mounting
----------	---

*\*Photometric values based upon tests performed in compliance with LM-79.*

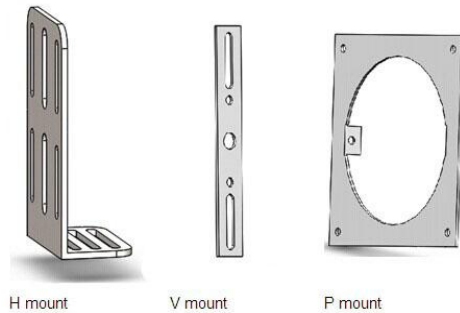

## Photometric Data

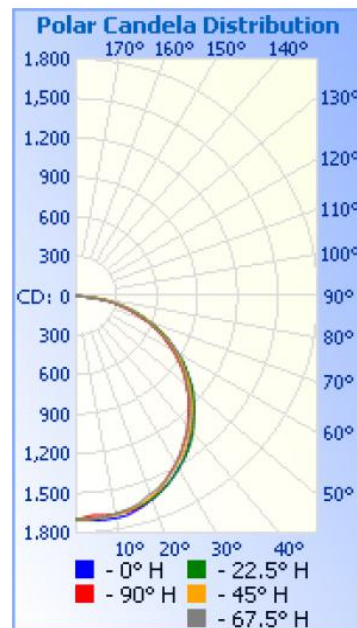

**Martek Industries, Inc**  
**The Experts in Responsible Lighting**  
**600 Deer Rd, Bldg 8**  
**Cherry Hill, NJ 08034**  
**www.marteklighting.com 856-427-9411**



# ML-RTUV-080



## Specification

### ELECTRICAL MEASUREMENTS

Input voltage	90-305VAC, 47-63 Hz
Input wattage	80W
Input current	0.80A
Equivalent wattage	250W MH
Power factor	0.90min
Total harmonic distortion	20% max.
Operating temp.	"-40°C to +45°C"

### PHOTOMETRIC CHARACTERISTICS

Initial Lumens Output	10000Lm
Initial Lumen Efficacy	125Lm/W
CCT	5000K/5500K/5700K
CRI	>70
Optics	120 deg./45 deg. (optional)

### LUMINOUS INTENSITY DISTRIBUTION

Center beam candlepower	2619cd
Beam angle	113.2° /45°

### PHYSICAL SPECIFICATION

Length	7.08" (180mm)
Width	5.51" (140mm)
Height	3.07" (78mm)
Housing material	Die cast aluminum
Finish	Silver
Module Weight	1182g
Driver Weight	793g
Packing Type	1 unit/white box,4 boxes/ctn.
Packing Dimension	300*275*130mm/315*290*540mm
Packing Weight	2.5kg/10kg

### MOUNTING AND WIRING

Mounting	Horizontal mounting Or vertical mounting Or custom plate mounting
----------	---

*\*Photometric values based upon tests performed in compliance*

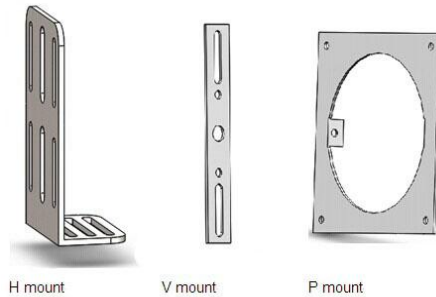

## Photometric Data

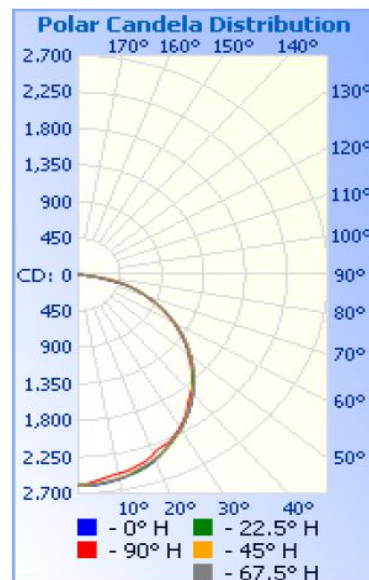

Martek Industries, Inc  
The Experts in Responsible Lighting  
600 Deer Rd, Bldg 8  
Cherry Hill, NJ 08034  
www.marteklighting.com 856-427-9411



# ML-RTUV-100



## Specification

### ELECTRICAL MEASUREMENTS

Input voltage	90-305VAC, 47-63 Hz
Input wattage	100W
Input current	1.2A
Equivalent wattage	350W MH
Power factor	0.90min
Total harmonic distortion	20% max.
Operating temp.	"-40°C to +45°C"

### PHOTOMETRIC CHARACTERISTICS

Initial Lumens Output	12500Lm
Initial Lumen Efficacy	125lm/W
CCT	5000K/5500K/5700K
CRI	70
Optics	120 deg./45 deg. (optional)

### LUMINOUS INTENSITY DISTRIBUTION

Center beam candlepower	2946cd
Beam angle	118.4° /45°

### PHYSICAL SPECIFICATION

Length	7.08" (180mm)
Width	5.51" (140mm)
Height	3.07" (78mm)
Housing material	Die cast aluminum
Finish	Silver
Module Weight	1182g
Driver Weight	1016g
Packing Type	1 unit/white box, 4 boxes/ctn.
Packing Dimension	300*275*130mm/315*290*540mm
Packing Weight	2.75kg/11kg

### MOUNTING AND WIRING

Mounting	Horizontal mounting Or vertical mounting Or custom plate mounting
----------	---

*\*Photometric values based upon tests performed in compliance*

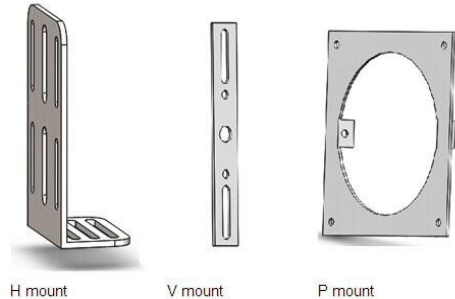

## Photometric Data

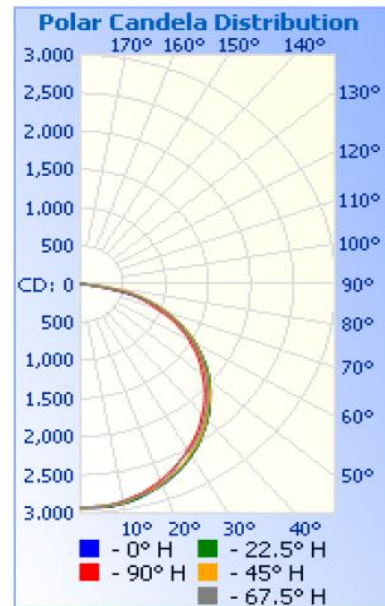

Martek Industries, Inc  
The Experts in Responsible Lighting  
600 Deer Rd, Bldg 8  
Cherry Hill, NJ 08034  
www.marteklighting.com 856-427-9411



# ML-RTUV-120

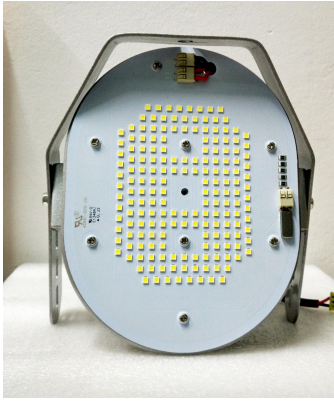

## Specification

### ELECTRICAL MEASUREMENTS

Input voltage	90-305VAC, 47-63 Hz
Input wattage	120W
Input current	1.40A
Equivalent wattage	400W MH
Power factor	0.90min
Total harmonic distortion	20% max.
Operating temp.	"-40°C to +45°C"

### PHOTOMETRIC CHARACTERISTICS

Initial Lumens Output	15000Lm
Initial Lumen Efficacy	125 lm/W
CCT	5000K/5500K/5700K
CRI	>70
Optics	120 deg./45 deg. (optional)

### LUMINOUS INTENSITY DISTRIBUTION

Center beam candlepower	3367cd
Beam angle	118.3° /45°

### PHYSICAL SPECIFICATION

Length	7.08" (180mm)
Width	5.51" (140mm)
Height	3.07" (78mm)
Housing material	Die cast aluminum
Finish	Silver
Module Weight	1182g
Driver Weight	1016g
Packing Type	1 unit/white box, 4 boxes/ctn.
Packing Dimension	300*275*130mm/315*290*540mm
Packing Weight	2.75kg/11kg

### MOUNTING AND WIRING

Mounting	Horizontal mounting Or vertical mounting Or custom plate mounting
----------	---

\*Photometric values based upon tests performed in compliance with LM-79.

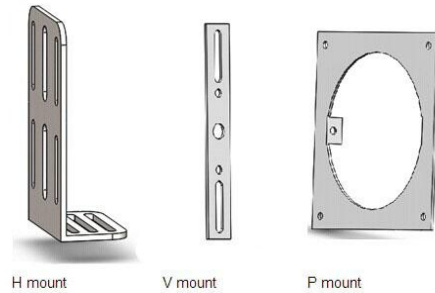

## Photometric Data

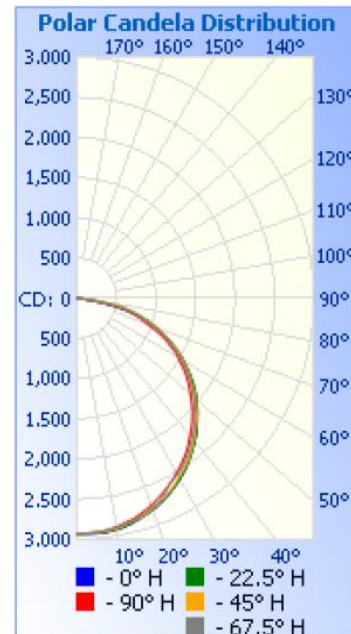

Martek Industries, Inc  
The Experts in Responsible Lighting  
600 Deer Rd, Bldg 8  
Cherry Hill, NJ 08034  
www.marteklighting.com 856-427-9411





# ML-RTUV-150



## Specification

### ELECTRICAL MEASUREMENTS

Input voltage	90-305VAC, 47-63 Hz
Input wattage	150W
Input current	1.70A
Equivalent wattage	450W MH
Power factor	0.90min
Total harmonic distortion	20% max.
Operating temp.	"-40°C to +45°C"

### PHOTOMETRIC CHARACTERISTICS

Initial Lumens Output	18750Lm
Initial Lumen Efficacy	125lm/W
CCT	5000K/5500K/5700K
CRI	72.7
Optics	120 deg./45 deg. (optional)

### LUMINOUS INTENSITY DISTRIBUTION

Center beam candlepower	4072cd
Beam angle	113.3° /45°

### PHYSICAL SPECIFICATION

Length	7.08" (180mm)
Width	5.51" (140mm)
Height	3.07" (78mm)
Housing material	Die cast aluminum
Finish	Silver
Module Weight	1182g
Driver Weight	1060g
Packing Type	1 unit/white box,4 boxes/ctn.
Packing Dimension	300*275*130mm/315*290*540mm
Packing Weight	3kg/12kg

### MOUNTING AND WIRING

Mounting	Horizontal mounting Or vertical mounting Or custom plate mounting
----------	---



*\*Photometric values based upon tests performed in compliance with LM-79.*

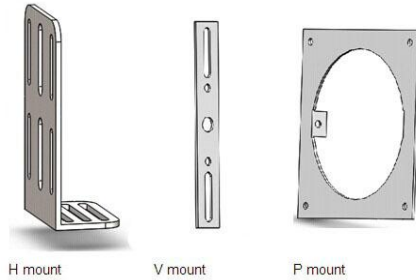

## Photometric Data

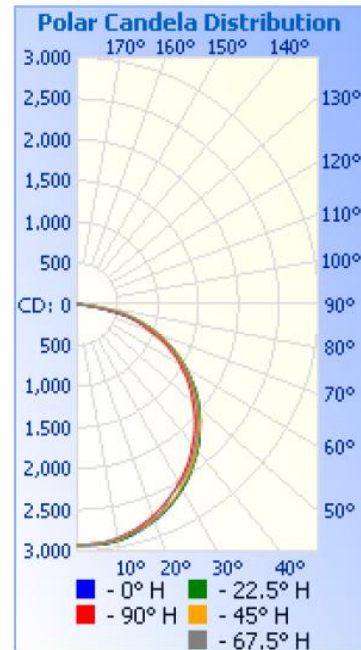

Martek Industries, Inc  
The Experts in Responsible Lighting  
600 Deer Rd, Bldg 8  
Cherry Hill, NJ 08034  
www.marteklighting.com 856-427-9411



# ML-RTUV-185



## Specification

### ELECTRICAL MEASUREMENTS

Input voltage	90-305VAC, 47-63 Hz
Input wattage	185W
Input current	2.10A
Equivalent wattage	600W MH
Power factor	0.90min
Total harmonic distortion	20% max.
Operating temp.	"-40°C to +45°C"

### PHOTOMETRIC CHARACTERISTICS

Initial Lumens Output	23125 Lm
Initial Lumen Efficacy	125 Lm/W
CCT	5000K/5500K/5700K
CRI	73.1
Optics	120 deg./45 deg. (optional)

### LUMINOUS INTENSITY DISTRIBUTION

Center beam candlepower	5056cd
Beam angle	112.7° /45°

### PHYSICAL SPECIFICATION

Length	10.43" (265mm)
Width	6.30" (160mm)
Height	3.07" (78mm)
Housing material	Die cast aluminum
Finish	Silver
Module Weight	1965g
Driver Weight	1060g
Packing Type	1 unit/white box, 4 boxes/ctn.
Packing Dimension	410*295*150mm/430*620*330mm
Packing Weight	4.2kg/16.80kg

### MOUNTING AND WIRING

Mounting	Horizontal mounting Or vertical mounting Or custom plate mounting
----------	---



\*Photometric values based upon tests performed in compliance with LM-79.

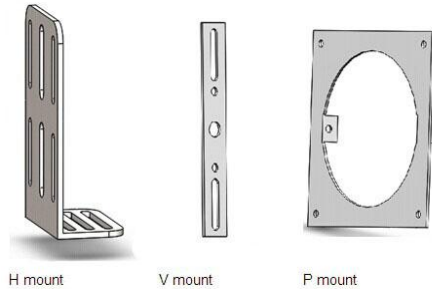

## Photometric Data

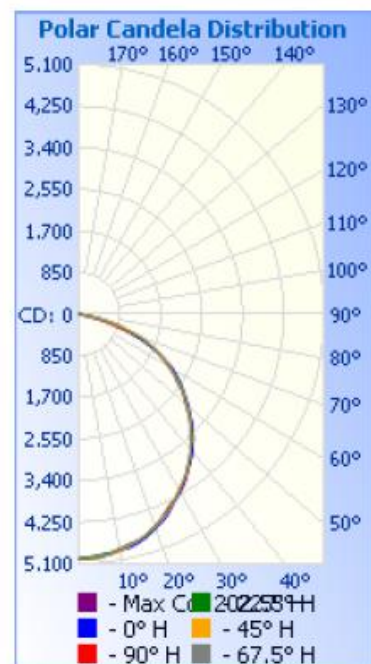

Martek Industries, Inc  
The Experts in Responsible Lighting  
600 Deer Rd, Bldg 8  
Cherry Hill, NJ 08034  
www.marteklighting.com 856-427-9411



# ML-RTUV-240



## Specification

### ELECTRICAL MEASUREMENTS

Input voltage	90-305VAC, 47-63 Hz
Input wattage	240 W
Input current	4.00A
Equivalent wattage	800W MH
Power factor	0.90min
Total harmonic distortion	20% max.
Operating temp.	"-40°C to +45°C"

### PHOTOMETRIC CHARACTERISTICS

Initial Lumens Output	30000Lm
Initial Lumen Efficacy	125 Lm/W
CCT	5000K/5500K/5700K
CRI	>70
Optics	120 deg./45 deg. (optional)

### LUMINOUS INTENSITY DISTRIBUTION

Center beam candlepower	6473 cd
Beam angle	113.9° /45°

### PHYSICAL SPECIFICATION

Length	10.43" (265mm)
Width	6.30" (160mm)
Height	3.07" (78mm)
Housing material	Die cast aluminum
Finish	Silver
Module Weight	1965g
Driver Weight	1185g
Packing Type	1 unit/white box,2 boxes/ctn.
Packing Dimension	410*295*150mm/425*310*320mm
Packing Weight	4kg/8kg

### MOUNTING AND WIRING

Mounting	Horizontal mounting Or vertical mounting Or custom plate mounting
----------	---

*\*Photometric values based upon tests performed in compliance with LM-79.*

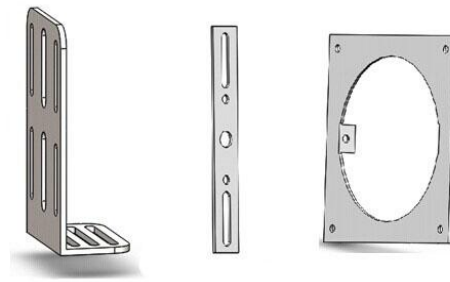

H mount

V mount

P mount

## Photometric Data

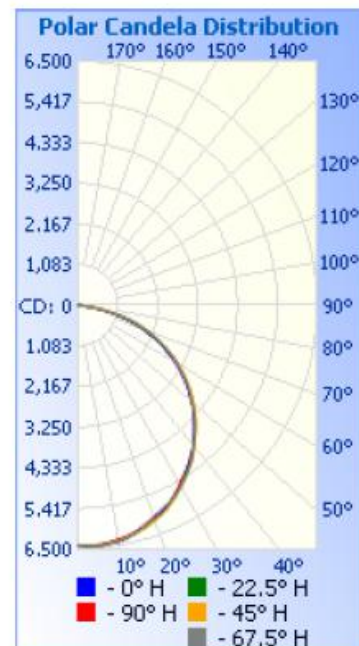

**Martek Industries, Inc**  
**The Experts in Responsible Lighting**  
**600 Deer Rd, Bldg 8**  
**Cherry Hill, NJ 08034**  
**www.marteklighting.com 856-427-9411**



# ML-RTUV-320

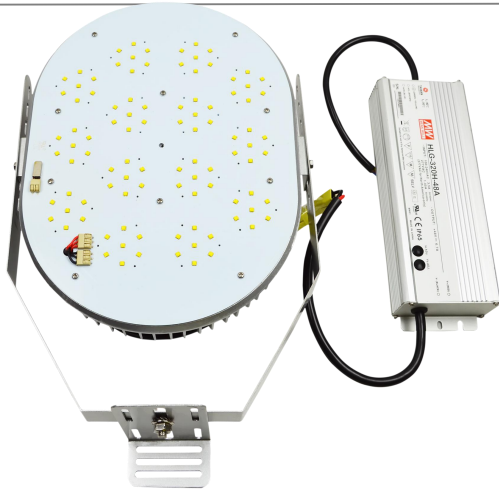

## Specification

### ELECTRICAL MEASUREMENTS

Input voltage	90-305VAC, 47-63 Hz
Input wattage	320 W
Input current	3.50A
Equivalent wattage	1000W MH
Power factor	0.90min
Total harmonic distortion	20% max.
Operating temp.	"-40°C to +45°C"

### PHOTOMETRIC CHARACTERISTICS

Initial Lumens Output	40000Lm
Initial Lumen Efficacy	125 Lm/W
CCT	5000K/5500K/5700K
CRI	>70
Optics	120 deg./45 deg. (optional)

### LUMINOUS INTENSITY DISTRIBUTION

Center beam candlepower	8483 cd
Beam angle	118° /45°

### PHYSICAL SPECIFICATION

Length	12.60" (320mm)
Width	9.33" (237mm)
Height	3.35" (85mm)
Housing material	Die cast aluminum
Finish	Silver
Module Weight	3360g
Driver Weight	1822g
Packing Type	1 unit/white box, 2 boxes/ctn.
Packing Dimension	450*435*150mm/465*450*320mm
Packing Weight	6kg/12kg

### MOUNTING AND WIRING

Mounting	Horizontal mounting Or vertical mounting Or custom plate mounting
----------	---

\*Photometric values based upon tests performed in compliance with LM-79.

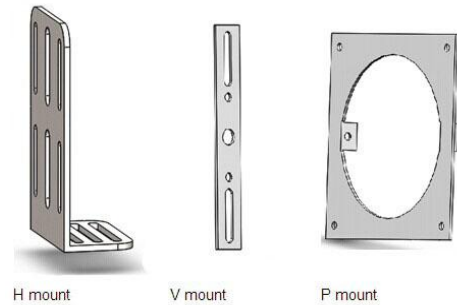

## Photometric Data

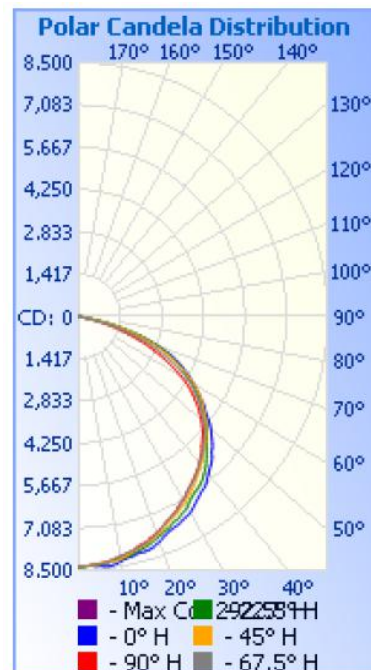

Martek Industries, Inc  
The Experts in Responsible Lighting  
600 Deer Rd, Bldg 8  
Cherry Hill, NJ 08034  
www.marteklighting.com 856-427-9411

